

DATA SHEET

VKK1-4A / VKK1R-4 Junction boxes

SPECIAL FEATURES

- Parallel connection of up to 4 load cells
- Off-center load compensation via integrated resistor network
- HBM shielding design Green-Line
- Degree of protection IP65 to EN 60 529
- VKK1R-4 with stainless housing

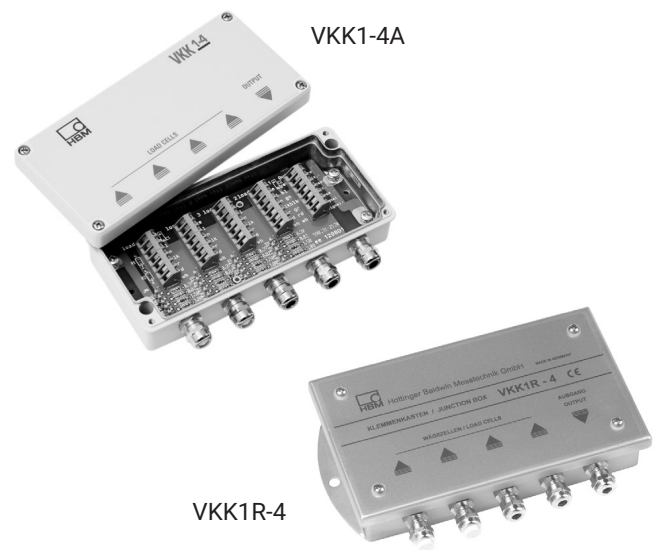

DIMENSIONS VKK1-4A

Dimensions (in mm; 1 mm = 0.03937 inches)

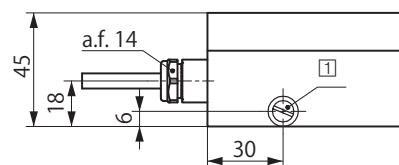
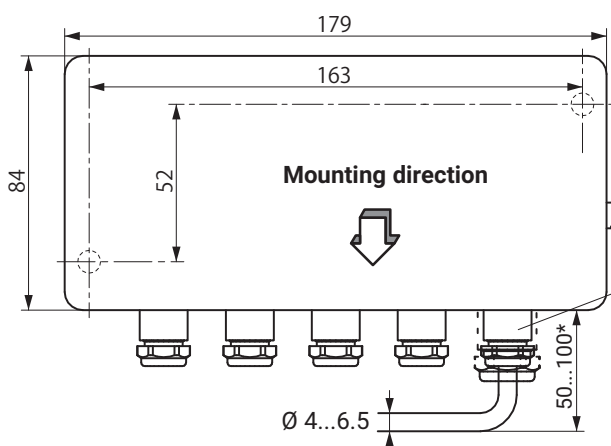

Included in scope of supply of VKK1-4A:
1 piece of special screws for cable diameter 7.5 mm, a.f. 17

- * depending on the cable type
-  Grounding screw M5x10 DIN 84

Suitable fastening screws: M4 DIN 84 or B3.9 DIN 7971 (minimum screw length 20 mm)

DIMENSIONS VKK1R-4

Dimensions (in mm; 1 mm = 0.03937 inches)

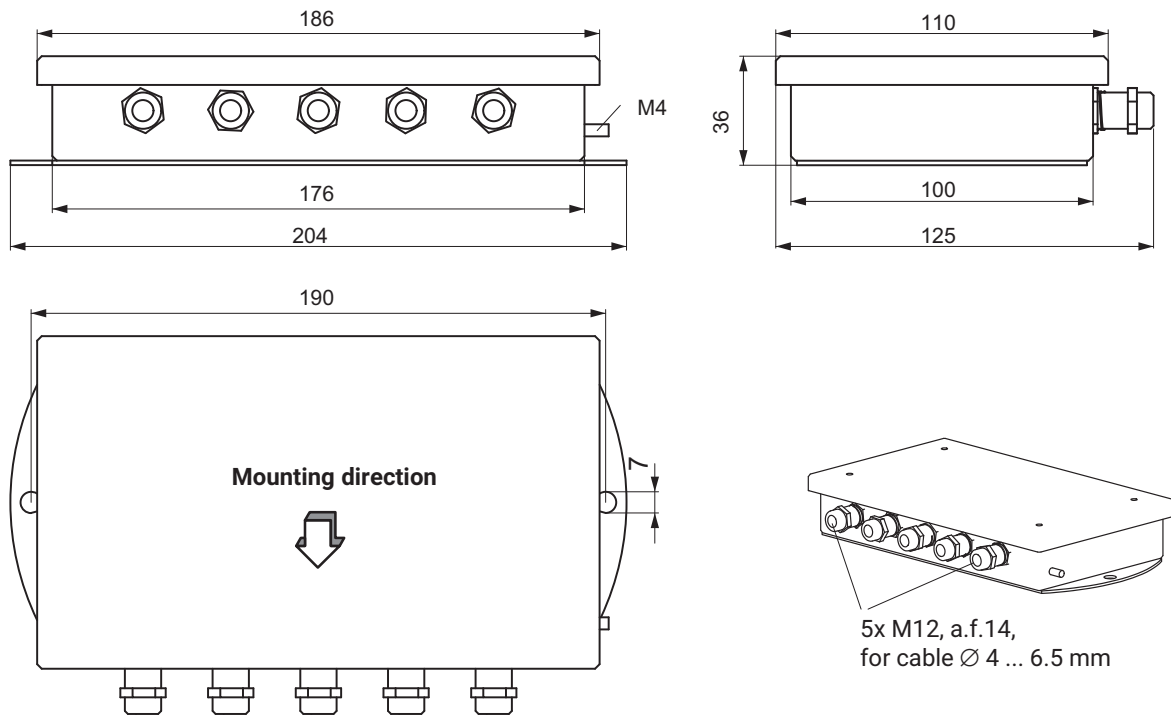

SPECIFICATIONS

Type		VKK1-4A	VKK1R-4
Resistor network for off-center load compensation	Ω	0.39...5.71 (in 15 steps)	
Max. permissible voltage	V	18	
Nominal temperature range	$^{\circ}\text{C}$ [$^{\circ}\text{F}$]	-20...+85 [-4...+185]	
Operating temperature range		-20...+85 [-4...+185]	
Storage temperature range		-40...+85 [-40...+185]	
Weight, approx.	kg	1	1.5
Max. wire cross section of cable strands	mm^2	1.5	
Degree of protection according to EN 60529 (IEC 529)		IP65 (protected against water jets)	
Materials			
Housing		Diecast aluminum, coated (color: RAL 7035)	Stainless steel, 1.4301
Sleeve nut		5x M12, SW14, nickel-plated brass	5x M12, SW14, nickel-plated brass
Clamping cone		Neoprene, for cable- \varnothing 4...6.5 mm ¹⁾)	Neoprene, for cable- \varnothing 4...6.5 mm
Screws		galvanized steel	steel 1.4301
Tightening torques (max.)			
PG seal	Nm	3	3
Cover screws		0.7	0.7

1) Included in scope of supply VKK1-4A: 1 piece special cable gland for cable diameter 7.5 mm, SW 17

RESISTOR NETWORK IN THE JUNCTION BOX

For off-center load compensation with 4 load cells

Input:
Load cells 1 ... 4

Output:
Amplifier

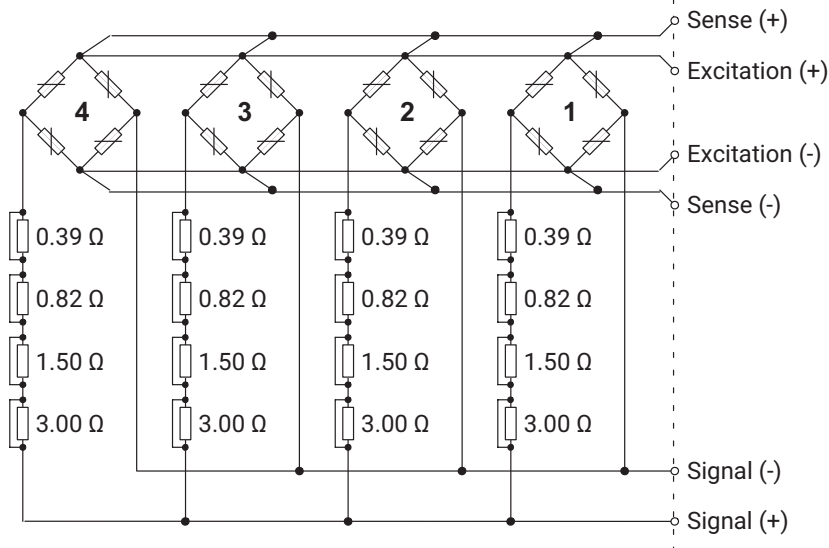

FUNCTION OF THE INTEGRATED RESISTOR NETWORK

The resistor network enables off-center load compensation for a scale to be easily made, if required.

Three steps have to be taken:

1. Load scale corners.
2. Read the correction value from the diagram (see mounting instructions).
3. Activate compensation resistor.

Hottinger Brüel & Kjaer GmbH

Im Tiefen See 45 · 64293 Darmstadt · Germany
Tel. +49 6151 803-0 · Fax +49 6151 803-9100
www.hbkworld.com · info@hbkworl.com

Subject to modifications. All product descriptions are for general information only. They are not to be understood as a guarantee of quality or durability.